





Michael Chandler

A fabulous terrace home in a very convenient and popular location. Diverse range of amenities immediately to hand and only a short distance to the City Centre. Generous living room with wood effect flooring open plan to the dining room. Modern fitted kitchen with integrated appliances, feature tiling and access to the rear yard. Two excellent first floor bedrooms in good decorative order. White bathroom suite contemporary tiling and plenty of natural light.

- 1 
- 2 
- 1 



HAPPY @ CAPPY !

Just off the Ravenhill Road near the junction with Ormeau Embankment the location of this delightful terrace is second to none with a diverse range of amenities immediately to hand, combined with Central Station and the City Centre only 1km away. Additionally Ormeau Park, Golf Club, Kingspan Rugby Stadium and a host of tempting bar-restaurants are also within striking distance.

The accommodation is well presented and benefits from tall ceilings with large windows creating excellent natural light and an airy, homely atmosphere throughout. The ground floor comprises a generous living room open plan to a dining area with a feature fireplace enhancing the ambience leading to modern kitchen with integrated oven and hob and access to the rear yard. There are two great bedrooms on the first floor and a modern bathroom with contemporary tiling.

Freshly decorated and with broad appeal to first time buyers, investors and speculators we invite you to come inside and appreciate the many charms of this delightful home.

Your Next Move...

Thinking of selling, it would be a pleasure to offer you a FREE VALUATION of your property.

Mortgage advice is also available from our in-house Mortgage Advisor, you can find out how much you can borrow within minutes instead of waiting weeks to go through your high street bank for a decision.

To arrange a viewing or for further information contact Michael Chandler Estate Agents on 02890 450 550 or email [property@michael-chandler.co.uk](mailto:property@michael-chandler.co.uk)

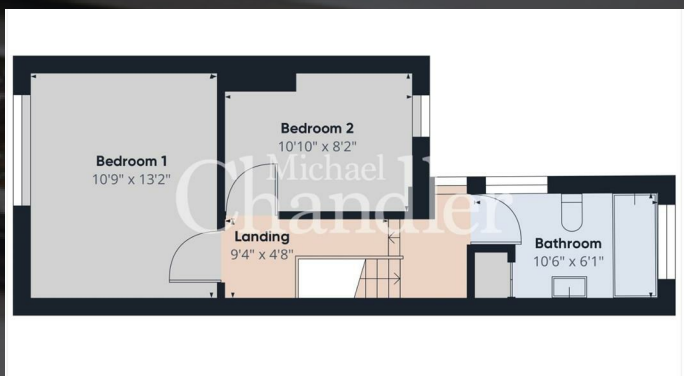

Mortgage advice is available from our in-house Mortgage Advisor, you can find out how much you can borrow within minutes!

### REQUEST VALUATION

We would be delighted to visit your property and give you a Free Valuation and some helpful advice regarding the sale or rental of your property to you!

513 Ormeau Road, Belfast, BT7 3GU

**02890 450 550**

[property@michael-chandler.co.uk](mailto:property@michael-chandler.co.uk)

[michael-chandler.co.uk](http://michael-chandler.co.uk)

Michael  
**Chandler**  
ESTATE AGENTS